

MECHANICAL TOL. ± 0.2 UNLESS SPECIFIED

APPROVAL	COUNTER DRAWING	CUSTOMER REF.	REV.	DATE
COMPANY NAME	STANDARD		00	17-AUG-06
APPROVED BY		SHEET 1 OF 2		
DATE		SCALE 3 : 1		

PROJECTION

S5063

APPROVAL	DRAFTING	CUSTOMER-SERVICE	ENGINEERING
APPROVED BY			
DATE			
DRAWN BY : ZH.Q.LI		UNIT IN mm	OUR REF. 00
✘ CLOVER DISPLAY LIMITED			

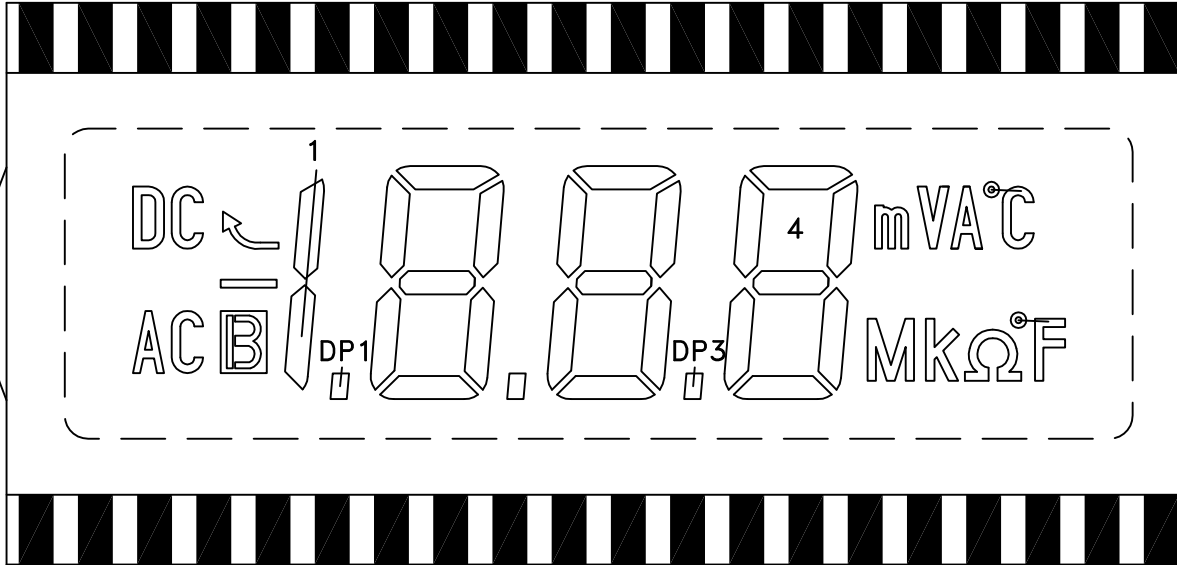

1

20

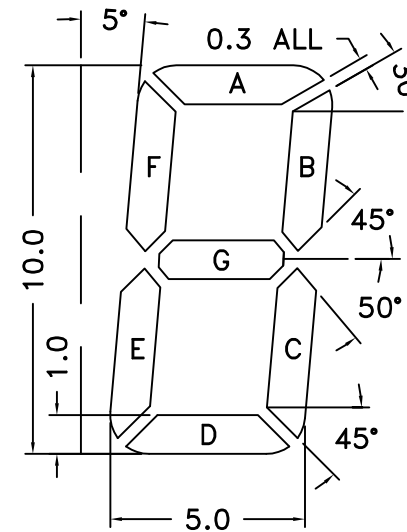

SCALE 5 : 1

PIN	COM	PIN	COM
1	COM	21	°F
2	/	22	°C
3	AC	23	A
4	B	24	V
5	1BC	25	m
6	1DP	26	4B
7	2E	27	4A
8	2D	28	4F
9	2C	29	4G
10	2DP	30	3B
11	3E	31	3A
12	3D	32	3F
13	3C	33	3G
14	3DP	34	2B
15	4E	35	2A
16	4D	36	2F
17	4C	37	2G
18	M	38	ARROW
19	K	39	MINUS
20	Ω	40	DC

TN TYPE

MODEL NO.	S5063A	S5063B	S5063C	S5063D	S5063E	S5063F	S5063G	S5063H
VIEWING DIRECTION	6 O'CLOCK	6 O'CLOCK	6 O'CLOCK	6 O'CLOCK	12 O'CLOCK	12 O'CLOCK	12 O'CLOCK	12 O'CLOCK
TEMPERATURE RANGE	OPERATE	0°C ~ 50°C	-20°C ~ 70°C	0°C ~ 50°C	-20°C ~ 70°C	0°C ~ 50°C	-20°C ~ 70°C	0°C ~ 50°C
	STORAGE	-10°C ~ 60°C	-30°C ~ 80°C	-10°C ~ 60°C	-30°C ~ 80°C	-10°C ~ 60°C	-30°C ~ 80°C	-30°C ~ 80°C
CONNECTOR	ZEBRA	ZEBRA	PIN	PIN	ZEBRA	ZEBRA	PIN	PIN

DISPLAY TYPE	POSITIVE / NEGATIVE REFLECTIVE / TRANSLUCTIVE / TRANSMISSIVE
OPERATION VOLTAGE	3.0 V
DRIVING METHOD	STATIC

REV.	REVISION RECORD	DATE	STANDARD	APPROVAL	DRAFTING	CUSTOMER-SERVICE	ENGINEERING
00	1st ISSUE	17-AUG-06	CUSTOMER REF.	APPROVED BY			
			SHEET 2 OF 2	DATE			
			SCALE 3 : 1	DRAWN BY : ZH.Q.LI	UNIT IN mm	OUR REF. 00	

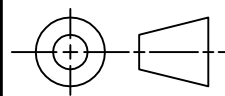

PROJECTION

S5063

✠ CLOVER DISPLAY LIMITED